

## Concrete screw JC2-KB

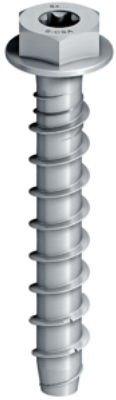

### Cross references

- Cleaning brush
- Blow-out pump
- Tool belt
- Hammer drill SDS plus
- Cordless hammer drills
- Cordless impact screwdrivers
- Socket wrench insert SW11, SW13, SW15
- Bit hexalobular TX30, TX40

### Application range

- > Facade scaffolds
- > Temporary fastenings
- > Contact surfaces
- > Shelves
- > Cable racks
- > Hand rails
- > Battens

### Properties

- > Zinc-plated steel
- > Hexagon head hexagon socket and pressed-on washer
- > ETA-approved concrete screw for cracked and non-cracked concrete
- > Self-tapping approved screw anchor for push-trough installation
- > No expansion therefore small edge and centre distances possible
- > Completely removable
- > For dry indoor use

### Technical specifications

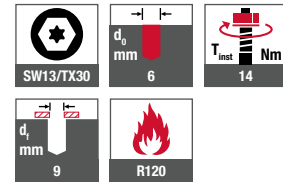

### Certifications



### Base materials

- Approved for
- > Cracked concrete
  - > Non-cracked concrete
  - > Pre-stressed hollow core slab

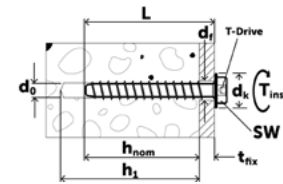

Characteristic values	Admissible loads non-cracked concrete C20/25			Admissible loads cracked concrete C20/25	
	$h_{ef}$ [mm]	$N_{Rec}$ [kN]	$V_{Rec}$ [kN]	$N_{Rec}$ [kN]	$V_{Rec}$ [kN]
<b>ETA-17/0835 – approval according to EAD 330232-00-0601 (option 1) for single fastening in concrete</b>					
JC2-KB 6	42.5	4.5	5.6*	2.1	4.5
<b>ETA-18/0221 – approval according to ETAG 001 part 6 for multiple fastening of non-structural systems in concrete</b>					
JC2-KB 6	27.6/31.9	1.4/1.7	5.4*/5.4*	1.4/1.7	5.4*/5.4*

\*Failure case = steel failure





**Product online**



Order description	L [mm]	t <sub>fix</sub> [mm]	h <sub>nom</sub> [mm]	h <sub>1</sub> [mm]	PU [pieces]	Price/100 [EUR]	Article number	EAN
<b>ETA-17/0835 – approval according to EAD 330232-00-0601 (option 1) for single fastening in concrete</b>								
Concrete screw JC2-KB-6x60/5/20 SW13	60	5	55	65	100		9650071310	4061245051222
<b>ETA-18/0221 – approval according to ETAG 001 part 6 for multiple fastening of non-structural systems in concrete</b>								
Concrete screw JC2-KB 6x45/5 SW13	45	5	40	50	100		9650071306	4061245051208
Concrete screw JC2-KB-6x50/10 SW13	50	10	40	50	100		9650071308	4061245051215
Concrete screw JC2-KB 6x60/5/20 SW13	60	20	40	50	100		9650071310	4061245051222